

5 Tons Geared Trolley Ex series spark resistant

Key features

- Adheres to the Council Directive and Standards in the EU for explosion proof manual chain hoists. 94/9/EC : ATEX EN1127-1 :2008, EN13463-1 : 2009, EN13463-5 : 2003
- Atex Protection Grade II 2 GD c II B T105 °C
- Note: It is the owner and/or user's responsibility to properly identify which spark resistant classification is required for their application, not the hoist manufacturer or distributor
- 3 Year Warranty, Customer Support and Service in the USA

Copyright: The pictures contained in this site belong to Prowinch LLC and are protected by copyright under national and international law. This information may not be reproduced, adapted or modified without the written consent of Prowinch LLC. The use of these images and texts implies that you should mention Prowinch LLC as owner. By consulting this site or downloading any information you agree to these conditions.

5 Tons Geared Trolley Ex series spark resistant

Technical Specifications

| | | | |
|---|---------------------------------------|-----------------------------|------------------------------|
| Rated Load Capacity | 5 Ton / 11000 lbs | I-Beam Width Range | 90 - 180 mm [3.54 - 7.08 in] |
| Load Test | 125% [Rated Load / Capacidad Nominal] | Minimum Turn Radius | 2.3 m [7.55 ft] |
| Standard Lifting Height | 20 ft / 6 m | Standards Compliance | ASME B30.17 / ATEX Directive |
| Explosion Proof Protection | Ex II 2 GD c II B T105 °C | Made in | Japan |
| Control | Geared Manual Chain | Warranty | 3 Year |
| Hand Chain Height (Customizable) | 6 m / 20 ft | | |

| Capacity / Capacidad | A | B | C | D | E | F | H | I | J | K |
|----------------------|------------------|-----------------|-----------------|------------------|-----------------|------------------|------------------|----------------|----------------|-----------------|
| 1102 lb / 0.5 t | 7.50 in / 191 mm | 5.0 in / 127 mm | 2.9 in / 74 mm | 6.1 in / 155 mm | 2.7 in / 69 mm | 3.9 in / 99 mm | 4.2 in / 107 mm | 1.3 in / 33 mm | 1.1 in / 33 mm | 3.9 in / 99 mm |
| 2204 lb / 1 t | 8.70 in / 221 mm | 5.0 in / 127 mm | 2.9 in / 74 mm | 6.7 in / 170 mm | 3.1 in / 79 mm | 4.5 in / 114 mm | 4.4 in / 112 mm | 1.2 in / 30 mm | 1.1 in / 28 mm | 4.0 in / 102 mm |
| 3527 lb / 1.5 t | 10.2 in / 262 mm | 5.6 in / 142 mm | 3.7 in / 94 mm | 8.1 in / 206 mm | 3.8 in / 97 mm | 5.3 in / 135 mm | 5.9 in / 150 mm | 2.0 in / 51 mm | 1.5 in / 38 mm | 5.5 in / 140 mm |
| 4409 lb / 2 t | 10.2 in / 260 mm | 5.6 in / 142 mm | 3.7 in / 94 mm | 8.1 in / 206 mm | 3.8 in / 97 mm | 5.3 in / 135 mm | 5.9 in / 150 mm | 2.1 in / 53 mm | 1.5 in / 38 mm | 5.5 in / 140 mm |
| 6944 lb / 3 t | 11.3 in / 287 mm | 5.7 in / 145 mm | 3.8 in / 97 mm | 9.4 in / 239 mm | 4.5 in / 114 mm | 5.9 in / 150 mm | 7.1 in / 180 mm | 2.5 in / 64 mm | 1.9 in / 48 mm | 6.6 in / 168 mm |
| 11023 lb / 5 t | 12.9 in / 328 mm | 6.5 in / 165 mm | 4.9 in / 124 mm | 11.4 in / 290 mm | 4.9 in / 124 mm | 6.6 in / 167 mm | 8.7 in / 221 mm | 2.9 in / 74 mm | 2.3 in / 58 mm | 8.2 in / 208 mm |
| 17636 lb / 8 t | 17.0 in / 432 mm | 6.5 in / 165 mm | 7.0 in / 178 mm | 13.0 in / 330 mm | 6.2 in / 157 mm | 8.6 in / 218 mm | 9.6 in / 243 mm | 3.9 in / 99 mm | 3.1 in / 79 mm | 9.1 in / 231 mm |
| 22046 lb / 10 t | 17.0 in / 432 mm | 7 in / 178 mm | | 13.0 in / 330 mm | 6.2 in / 157 mm | 8.6 in / 218 mm | 9.6 in / 243 mm | 3.9 in / 99 mm | 3.1 in / 79 mm | 9.1 in / 231 mm |
| 33069 lb / 15 t | 22.8 in / 579 mm | 9 in / 229 mm | | 18.2 in / 462 mm | 7.7 in / 196 mm | 11.6 in / 295 mm | 10.7 in / 272 mm | 3.3 in / 84 mm | 3.7 in / 94 mm | 9.7 in / 246 mm |
| 44092 lb / 20 t | 22.8 in / 579 mm | 9 in / 229 mm | | 18.2 in / 462 mm | 7.7 in / 196 mm | 11.6 in / 295 mm | 10.7 in / 272 mm | 3.3 in / 84 mm | 3.7 in / 94 mm | 9.7 in / 246 mm |

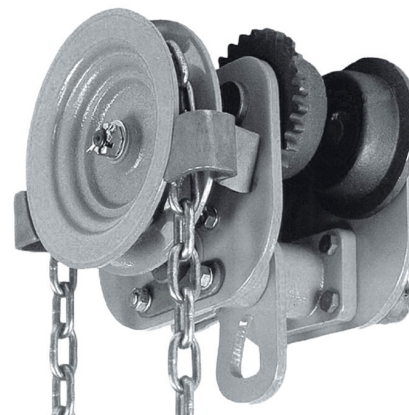
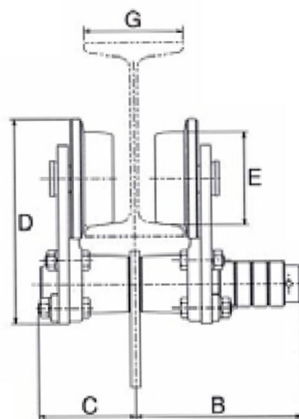
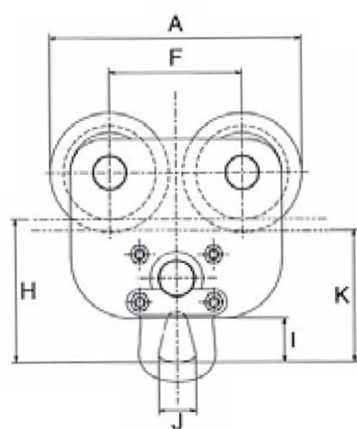

Referential Images
Specifications may change without notice

Unit Weight & Dimensions

| | | | |
|---------------------------|---|-----------------------------|-----------------|
| H Minimum Headroom | 630 mm [24.8 in] Combined Hoist Trolley | Hand Chain Size | 6 x 26.6 |
| X Wheels Diameter | 125 mm [4.9 in] | Package 1 Net Weight | 121 lbs / 55 Kg |
| Total Unit Weight | 121 lbs / 55 Kg | | |

Packaging Weight & Dimensions