



2 Speed 1/2 Ton Electric Chain Hoist Power Trolley 20 ft FEC G80 Japan M5/H4 220~240/460V Wireless

Key features

- UL 1340 File No E528915, ASME HST-1 , ASME B30.16 , EN14492-2 , EN60204-32
- Heavy Duty H4/M5 Aluminum housing, NSK Bearings, USA Chevron Meropa 320 Lube
- Overload Protection and Super Heavy Duty FEC G80 Chain, MADE IN JAPAN. Standard ASTM A973
- German Brand Schneider Contactors, All ways Limit Switches, Emergency Stop
- 3 Year Warranty, Customer Support and Service in the USA

2 Speed 1/2 Ton Electric Chain Hoist Power Trolley 20 ft FEC G80 Japan M5/H4 220~240/460V Wireless

Prowinch Two Speed Electric Chain Hoist with Power Trolley

All of our Electric Chain Hoists are created with the goal of offering the best price-performance ratio. Key components such as lifespan factors are constantly tested and improved in order to offer the best product for the price.

Key Components

All internal components have been upgraded to meet the highest quality standards. Key electronic components are produced by American or German brands, and we use American-made lubricants to ensure the lifespan of gears and reducers. Final assembly and all tests are performed in the US before shipping to ensure that every unit meets the corresponding standard.

Duty Classification

Duty Classification is a key factor when choosing the right unit. These H4 hoists are suitable for high-volume handling in steel warehouses, machine shops, fabricating plants and mills, and foundries. For uniformly distributed work periods, the hoists have 50% max. operational time per hour and can handle up to 300 starts per hour. When being used for infrequent work periods, the hoist can be operated for 30 minutes from a cold start with up to 300 starts per hour. Operational time ratings are calculated at a 65% load factor, as per ASME HST-1-2012.

Control System

This electric chain hoist comes standard with an industrial wireless remote control and a pendant control. The length of the pendant control is 4 feet less than the lifting height, which allows it to be easily operated from ground-level.

Braking System

The electromagnetic brake system is tested at 125% of the hoist capacity and is designed to automatically engage immediately upon any loss of power.

Technical Specifications

Rated Load Capacity	1100 lbs / 500 kg	Emergency Stop	Yes
Standard Lifting Height	20 ft / 6 m	Load Chain Type	G80 JAPAN
Speed /min	2.6 / 8 min/m	Load Chain Size	6.3 x 19 mm
Number of Speeds	2 Speed	Chain Falls	1
Voltage	3 Phase 208~240/440~480V 50/60Hz	Chain Length	20 ft / 6 m
Total Power Watts	900	Humidity	<85%
FCC ID	2AZMK-Q1212	Temperature	-4 ~ 104° F / -20 ~ 40° C
Duty Class	H4/M5/2m/Class D	Noise Level	81 dB
Motor/Engine Power	0.9 kW	Trolley Number of Speeds	1
Motor Brake	Yes	I-Beam Width Range	5 - 7 inches
Insulation Grade	F	Standards Compliance	UL 1340, ASME HST-1 , ASME B30.16 , B30.17, EN60204-32
IEC Motor Protection	IP55	UL File	MSXT.E528915 - Hoists
Control	Wireless PW-Q404 and Pendant Control	Warranty	3 Year
Control Voltage	24V		

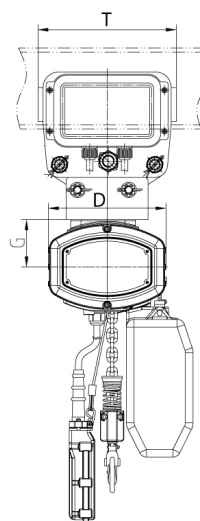
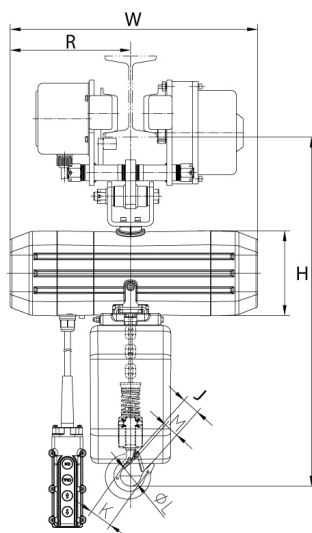

Unit Weight & Dimensions

T Trolley Motor Width	4.8 in / 12.4 cm
W Width	18.1 in / 45.8 cm
H Minimum Headroom	17.9 in / 45.5 cm
J Hook Opening	1.46 in / 3.7 cm
D Depth	9.1 in / 22.9 cm
Total Unit Weight	188 lbs / 86 Kg

Packaging Weight & Dimensions

Package 1 Net Weight	93 lbs / 42 Kg
Package 2 Net Weight	95 lbs / 43 Kg
Package 1 Gross Weight	123 lbs / 56 Kg
Package 2 Gross Weight	130 lbs / 59 Kg
Package 1 Length	24 in / 60.96 cm
Package 2 Length	29 in / 73.66 cm
Package 1 Width	19 in / 48.26 cm
Package 2 Width	19 in / 48.26 cm
Package 1 Height	18 in / 45.72 cm
Package 2 Height	18 in / 45.72 cm