



300 Lb Mini Electric Chain Hoist Power Trolley 15 ft Chain H3 110V

Key features

- High quality Hoist with UL Certification
- Overload Protection and Heavy Duty, Durable G100 Chain
- Key safety features such as all-way limit switches, emergency stop, and automatic brake system.
- Meets US and EU Standards ASME HST-1, ASME B30.16, EN14492-2, EN60204-32.
- 3 Year Warranty, Customer Support and Service in the USA

300 Lb Mini Electric Chain Hoist Power Trolley 15 ft Chain H3 110V

Prowinch Electric Chain Hoist

All of our **Electric Chain Hoists** are created with the goal of offering the best price-performance ratio. Key components such as lifespan factors are constantly tested and improved in order to offer the best product for the price.

Key Components

All internal components have been upgraded to meet the highest quality standards. Key electronic components are produced by American or German brands, and we use American-made lubricants to ensure the lifespan of gears and reducers. Final assembly and all tests are performed in the US before shipping to ensure that every unit meets the corresponding standard.

Duty Classification

Duty classification is a key factor when choosing the right unit. These H3 hoists are suitable for general machine shop fabricating, assembly, storage, and warehousing. For uniformly distributed work periods, the hoists have 25% max. operational time per hour and can handle up to 150 starts per hour. When being used for infrequent work periods, the hoist can be operated for 30 minutes from a cold start with up to 200 starts per hour. Operational time ratings are calculated at a 65% load factor, as per ASME HST-1-2012.

Control System

This **Electric Chain Hoist** comes with a pendant control with up, down, and emergency stop. The length of the pendant control is 4 feet less than the lifting height, which allows it to be easily operated from ground-level.

Braking System

The **electromagnetic brake system** is tested at 125% of the hoist capacity and is designed to automatically engage immediately upon any loss of power.

Technical Specifications

Rated Load Capacity	300 lbs / 135 kg	Emergency Stop	Yes
Standard Lifting Height	15 ft / 4.5 m	Load Chain Type	G100
Speed /min	14 ft / 4.3 m	Load Chain Size	5*15 mm
Number of Speeds	1 Speed	Chain Falls	2
Voltage	1 Phase 110~120V 60Hz	Chain Length	15 ft / 4.5 m
Total Power Watts	130	Humidity	<85%
Duty Class	H3/M4/1Am/Class C	Temperature	-4 ~ 104° F / -20 ~ 40° C
Motor/Engine Power	0.17 kw	Noise Level	81 dB
Motor Brake	Yes	Trolley Number of Speeds	1
Insulation Grade	F	I-Beam Width Range	3 - 7in
IEC Motor Protection	IP55	Standards Compliance	UL 1340 - ASME HST-1 , ASME B30.16, EN60204-32
Control	Pendant Control	UL File	MSXT.E528915 - Hoists
Control Voltage	24V	Warranty	3 Year

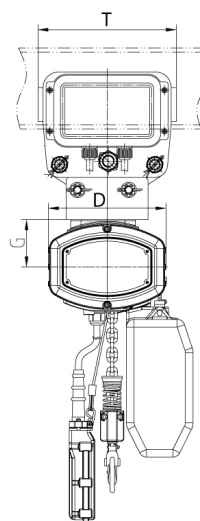
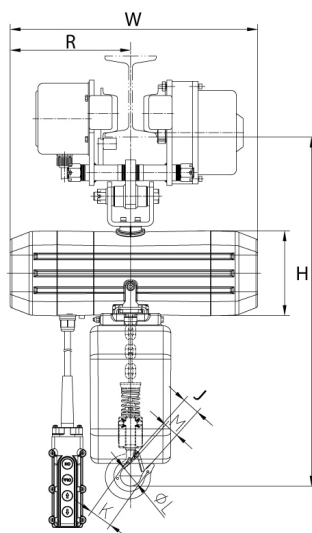

Unit Weight & Dimensions

H Minimum Headroom	14.6 in / 37 cm
J Hook Opening	1 in / 2.6 cm
D Depth	6 in / 15 cm
X Wheels Diameter	3.75in
W Width	14.1 in / 36 cm
Total Unit Weight	109 lbs / 50 Kg

Packaging Weight & Dimensions

Package 1 Net Weight	28 lbs / 13 Kg
Package 2 Net Weight	81 lbs / 37 Kg
Package 1 Gross Weight	50 lbs / 23 Kg
Package 2 Gross Weight	117 lbs / 53 Kg
Package 1 Length	18 in / 45.72 cm
Package 2 Length	29 in / 73.66 cm
Package 1 Width	14 in / 35.56 cm
Package 2 Width	19 in / 48.26 cm
Package 1 Height	16 in / 40.64 cm
Package 2 Height	18 in / 45.72 cm