



20000 lbs Electric Waterproof Winch Wireless 12V DC

Key features

- IP67 Waterproof protection.
- Convenient remote control that can be used wired or wireless.
- All-Steel, 3 stage planetary gearbox.
- Reliable Drum Brake Designed to Automatically Engage upon any Loss of Power.
- 3 Year Warranty, Customer Support and Service in the USA

Winch Description

Our **20,000 lbs Electric Waterproof Recovery Winch 12V** is the ultimate winch for tough pulls. This winch has been tried and tested even in the most rugged conditions. With an impressive IP67 rating this winch can perform even when submerged in water of up to one meter. Helping you complete your recovery job with ease.

Prowinch Electric DC Winches

All of our electric DC winches are created with the goal of offering the best price-performance ratio. Key components such as lifespan factors are constantly tested and improved in order to offer the best product for the price.

Key Components

All internal components have been upgraded to meet the highest quality standards. Key electronic components are produced by American or German brands, and we use American-made lubricants to ensure the lifespan of gears and reducers. Final assembly and all tests are performed locally at Prowinch facility before shipping to ensure that every unit meets the corresponding standard.

Control System

This winch includes a 12V wired remote control. The winch contains the best electric components available on the market, and everything is made, assembled, and tested locally in the US, Chile, or Colombia.

Braking System

Prowinch electric DC winches include a sliding ring gear clutch and an in drum automatic brake. Automatic brake system designed to automatically engage immediately upon any loss of power.

Technical Specifications

1st Layer Rated Capacity	20000 lbs	Motor AMP	450 AMP
Speed /min	3.4~17 ft / 1~5 m	IEC Motor Protection	IP67
Number of Speeds	1 Speed	Control	Wireless and Wired
Wire rope capacity per layer first/last	20,000 / 10,550	Transmission / Reducer Type	4-Stage Planetary
Voltage	Battery Power 12 VDC	Gear Ratio	544:1
FCC ID	2ASYP-DW12K	Drum Brake	In-Drum Automatic Brake
Duty Class	Recovery / Rescate	Free Spooling Clutch Type	Sliding Ring Gear
Motor/Engine Type	DC Series Wound Motor	Wire Rope	Steel $\phi 1/2$ in x 72 ft $\phi 13$ mm x 22 m
Motor/Engine Power	6.6 HP	Warranty	3 Year

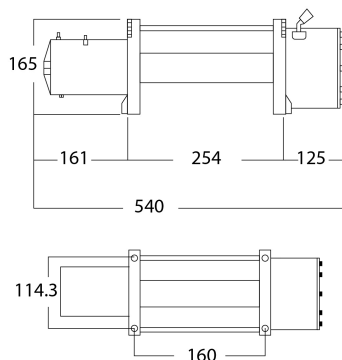

Dimensions in mm / Dimensiones en mm

INCLUDED/ INCLUIDO

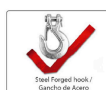

OPTIONAL / OPCIONAL

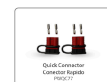

Unit Weight & Dimensions

BD Barrel Diameter	89 mm	Package 1 Net Weight	138 lbs / 63 Kg
J Hook Opening	31 mm	Package 1 Width	23 in / 58.42 cm
DL Drum Length	228 mm	Package 1 Gross Weight	143 lbs / 65 Kg
Total Unit Weight	138 lbs / 63 Kg	Package 1 Height	12 in / 30.48 cm
		Package 1 Length	12 in / 30.48 cm

Packaging Weight & Dimensions