



20000 lbs Electric Waterproof Winch Wire Rope 24V

Key features

- IP67 Waterproof protection.
- Convenient Remote Control that Can be Used Wired or Wireless.
- All-Steel, 3 stage planetary gearbox.
- Reliable Drum Brake Designed to Automatically Engage upon any Loss of Power.
- 3 Year Warranty, Customer Support and Service in the USA

Electric Winch Description

This Prowinch **20,000 lbs 24V Electric Winch** offers ultimate pulling power. The winch is IP67 waterproof and comes with a handy wireless control, which make it perfect for a wide variety of uses such as off-roading and towing.

Prowinch 24V Electric Winch

All of our **AC electric winches** are created with the goal of offering the best price-performance ratio. Key components such as lifespan factors are constantly tested and improved in order to offer the best product for the price.

Key Components

All internal components have been upgraded to meet the highest quality standards. Final assembly and all tests are performed locally at Prowinch facility before shipping to ensure that every unit meets the corresponding standard.

Control System

These winches feature a unique remote control design, which allows the winch to be operated wired or wirelessly.

Braking System

Automatic brake system designed to automatically engage immediately upon any loss of power.

Technical Specifications

1st Layer Rated Capacity	20000 lbs	IEC Motor Protection	IP67
Speed /min	3.4~17 ft / 1~5 m	Control	Wireless and Wired
Number of Speeds	1 Speed	Transmission / Reducer Type	4-Stage Planetary
Wire rope capacity per layer first/last	20,000 / 10,550	Gear Ratio	544:1
Voltage	Battery Power 24 VDC	Reducer Brake	In-Drum Automatic Brake
FCC ID	2ASYP-DW12K	Drum Brake	Automatic
Duty Class	Recovery / Rescate	Free Spooling Clutch Type	Sliding Ring Gear
Motor/Engine Type	DC Series Wound Motor	Wire Rope	Steel ϕ 1/2 in x 72 ft ϕ 13 mm x 22 m
Motor/Engine Power	6.6 HP	Warranty	3 Year
Motor AMP	323 AMP		

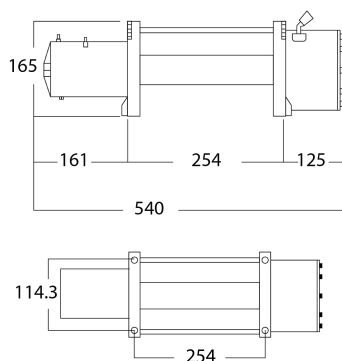

Dimensions in mm / Dimensiones en mm

INCLUDED/ INCLUIDO

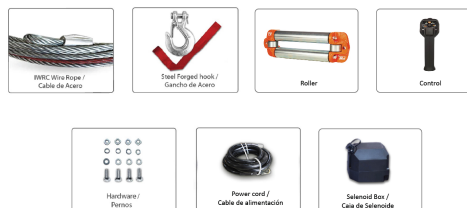

OPTIONAL / OPCIONAL



Unit Weight & Dimensions

BD Barrel Diameter	89 mm	Package 1 Net Weight	138 lbs / 63 Kg
DL Drum Length	228 mm	Package 1 Width	23 in / 58.42 cm
Total Unit Weight	138 lbs / 63 Kg	Package 1 Gross Weight	143 lbs / 65 Kg
		Package 1 Height	12 in / 30.48 cm
		Package 1 Length	12 in / 30.48 cm

Packaging Weight & Dimensions