



20000 lbs Electric Winch Waterproof 12V DC Wireless

Key features

- Sturdy 20,000lb rated line pull powered by 6.6 HP 12V DC motor.
- Convenient remote control that can be used wired or wireless.
- Pull and turn free spooling clutch; Gearing 4 Stage Planetary.
- Equipped with an in drum automatic brake.
- 3 Year Warranty, Customer Support and Service in the USA

Winch Description

This **20,000 lbs Electric Recovery Winch 12V** will help you in any recovery situation. No matter the terrain this dependable winch is the key partner every rider needs. With a powerful 20,000lb load capacity and 6HP motor, this electric winch will give you the results you need. Use this winch with confidence as it includes a 3 Year Warranty.

Prowinch Electric DC Winches

All of our electric DC winches are created with the goal of offering the best price-performance ratio. Key components such as lifespan factors are constantly tested and improved in order to offer the best product for the price.

Key Components

All internal components have been upgraded to meet the highest quality standards. Key electronic components are produced by American or German brands, and we use American-made lubricants to ensure the lifespan of gears and reducers. Final assembly and all tests are performed locally at Prowinch facility before shipping to ensure that every unit meets the corresponding standard.

Control System

This winch includes a 12V wired remote control. The winch contains the best electric components available on the market, and everything is made, assembled, and tested locally in the US, Chile, or Colombia.

Braking System

Prowinch electric DC winches include a sliding ring gear clutch and an in drum automatic brake. Automatic brake system designed to automatically engage immediately upon any loss of power.

Technical Specifications

1st Layer Rated Capacity	20000 lbs	Motor AMP	450 AMP
Speed /min	3.4~17 ft / 1~5 m	IEC Motor Protection	IP67
Number of Speeds	1 Speed	Control	Wireless and Wired
Wire rope capacity per layer first/last	20,000 / 8,000	Transmission / Reducer Type	4-Stage Planetary
Voltage	Battery Power 12 VDC	Gear Ratio	544:1
FCC ID	2ASYP-DW12K	Drum Brake	In-Drum Automatic Brake
Duty Class	Recovery / Rescate	Free Spooling Clutch Type	Sliding Ring Gear
Motor/Engine Type	DC Series Wound Motor	Wire Rope	Steel $\phi 9/16$ in x 85 ft $\phi 14$ mm x 26 m
Motor/Engine Power	6.6 HP	Warranty	3 Year

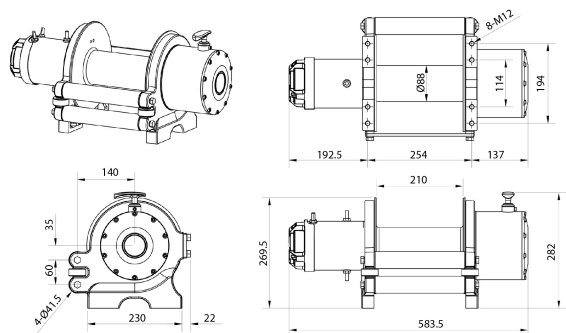

Dimensions in mm / Dimensiones en mm

INCLUDED / INCLUIDO

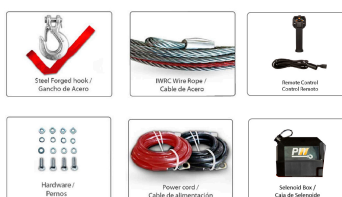

OPTIONAL / OPCIONAL



Unit Weight & Dimensions

A Total Height	335 mm	Package 1 Net Weight	188 lbs / 85 Kg
BD Barrel Diameter	89 mm	Package 1 Width	21 in / 53.34 cm
D Depth	285 mm	Package 1 Gross Weight	165 lbs / 75 Kg
DL Drum Length	228 mm	Package 1 Height	20 in / 50.8 cm
W Width	560 mm	Package 1 Length	25 in / 63.5 cm
J Hook Opening	31 mm		
Total Unit Weight	188 lbs / 86 Kg		

Packaging Weight & Dimensions