



20000 lbs Electric Waterproof Winch Wire Rope 24V Wireless

Key features

- IP67 Waterproof protection.
- Convenient Remote Control that Can be Used Wired or Wireless.
- All-Steel, 3 stage planetary gearbox.
- Reliable Drum Brake Designed to Automatically Engage upon any Loss of Power.
- 3 Year Warranty, Customer Support and Service in the USA

Electric Winch Description

This Prowinch **20,000 lbs 24V Electric Winch** offers an excellent combination of power and performance. The strong, durable, IP67 waterproof winch allows you to complete even the most difficult jobs with ease. The IP67 waterproof rating allows you to use the winch even in adverse conditions.

Prowinch 24V Electric Winch

All of our **AC electric winches** are created with the goal of offering the best price-performance ratio. Key components such as lifespan factors are constantly tested and improved in order to offer the best product for the price.

Key Components

All internal components have been upgraded to meet the highest quality standards. Final assembly and all tests are performed locally at Prowinch facility before shipping to ensure that every unit meets the corresponding standard.

Control System

These winches feature a unique remote control design, which allows the winch to be operated wired or wirelessly.

Braking System

Automatic brake system designed to automatically engage immediately upon any loss of power.

Technical Specifications

1st Layer Rated Capacity	20000 lbs	IEC Motor Protection	IP67
Speed /min	3.4~17 ft / 1~5 m	Control	Wireless and Wired
Number of Speeds	1 Speed	Transmission / Reducer Type	4-Stage Planetary
Wire rope capacity per layer first/last	20,000 / 8,000	Gear Ratio	544:1
Voltage	Battery Power 24 VDC	Reducer Brake	In-Drum Automatic Brake
FCC ID	2ASYP-DW12K	Drum Brake	Automatic
Duty Class	Recovery / Rescate	Free Spooling Clutch Type	Sliding Ring Gear
Motor/Engine Type	DC Series Wound Motor	Wire Rope	Steel ø9/16 in x 85 ft ø14 mm x 26 m
Motor/Engine Power	6.6 HP	Warranty	3 Year
Motor AMP	323 AMP		

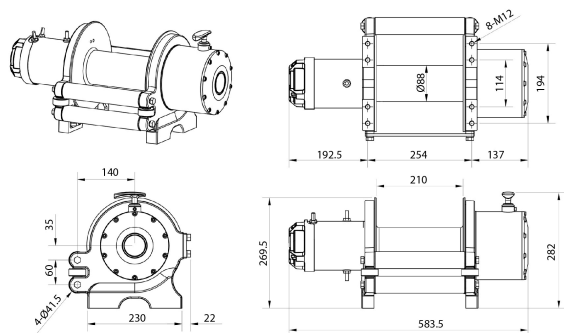

Dimensions in mm / Dimensiones en mm

INCLUDED / INCLUIDO

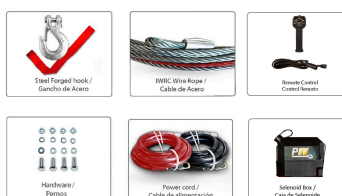

OPTIONAL / OPCIONAL



Unit Weight & Dimensions

A Total Height	335 mm	Package 1 Net Weight	90 lbs / 41 Kg
BD Barrel Diameter	89 mm	Package 1 Width	19 in / 48.26 cm
D Depth	285 mm	Package 1 Gross Weight	182 lbs / 83 Kg
DL Drum Length	228 mm	Package 1 Height	19 in / 48.26 cm
W Width	560 mm	Package 1 Length	25 in / 63.5 cm
Total Unit Weight	90 lbs / 41 Kg		

Packaging Weight & Dimensions