

Permanent Magnetic Lifter 11000 lb. / 5000 kg

Key features

- Features a high-performance permanent neodymium magnet, strong in magnetic pull and light weight
- "V" style design can lift round steel objects like steel pipes
- 2.5:1 safety factor, it has high safety performance and higher efficiency
- The magnetic lifter can be used to lift steel sheets, blocks, rods, cylinders and other steel materials
- 3 Year Warranty, Customer Support and Service in the USA

Permanent Magnetic Lifter 11000 lb. / 5000 kg

Technical Specifications

Rated Load Capacity	11000 lb / 5000 kg Max. pull off: 33070 lb / 15000 kg	Warranty	3 Year
Operating Temperature Range	<176°F / 80°C		

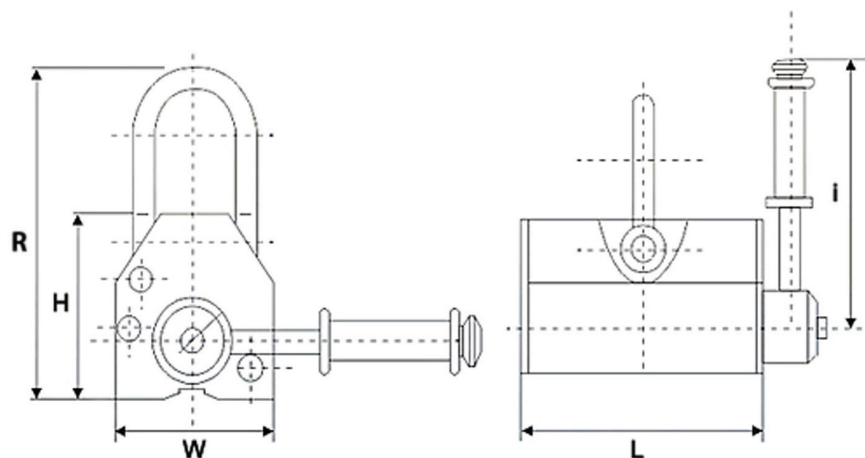

Model/Modelo		PWML100	PWML400	PWML600	PWML1000	PWML2000	PWML3000	PWML4000	PWML5000
Size /Tamaño	L	4 in / 90 mm	6 in / 160 mm	9 in / 220 mm	10 in / 260 mm	13 in / 340 mm	17 in / 420 mm	19 in / 480 mm	23 in / 580 mm
	W	3 in / 63.5 mm	4 in / 95 mm	5 in / 115 mm	6 in / 145 mm	6 in / 160 mm	7 in / 185 mm	8 in / 200 mm	12 in / 300 mm
	H	3 in / 68 mm	7 in / 180 mm	5 in / 125 mm		6 in / 165 mm			
	R	6 in / 145 mm	8 in / 210 mm	9 in / 230 mm	11 in / 280 mm	16 in / 410 mm	20 in / 510 mm		26 in / 650 mm
Magnet Activation		Locking ON/OFF Handle							
Activación del magneto		Palanca ON/OFF							

Unit Weight & Dimensions

Total Unit Weight	436 lbs / 198 Kg
--------------------------	------------------

Packaging Weight & Dimensions

Package 1 Net Weight	436 lbs / 198 Kg
Package 1 Width	15 in / 38.1 cm
Package 1 Gross Weight	469 lbs / 213 Kg
Package 1 Height	27 in / 68.58 cm
Package 1 Length	18 in / 45.72 cm