



## Fixed Pulley Diameter 396mm for 22mm cable 10 Tons F 4 to 1

### Key features

- 3 Year Warranty, Customer Support and Service in the USA

Fixed Pulley Diameter 396mm for 22mm cable 10 Tons F 4 to 1

### Prowinch Snatch Blocks Pulleys

All of our **Snatch Blocks Pulleys** are created with the goal of offering the best quality and performance. Key components such as lifespan factors are constantly tested and improved in order to offer the best product for the price.

## Technical Specifications

<b>Rated Load Capacity</b>	22046 lb / 10000 kg	<b>Standards Compliance</b>	ASME B30.22
<b>Compatible wire rope</b>	7/8 in / 22 mm	<b>Warranty</b>	3 Year
<b>Pulley Diameter</b>	Ø15.7 in / Ø400 mm		

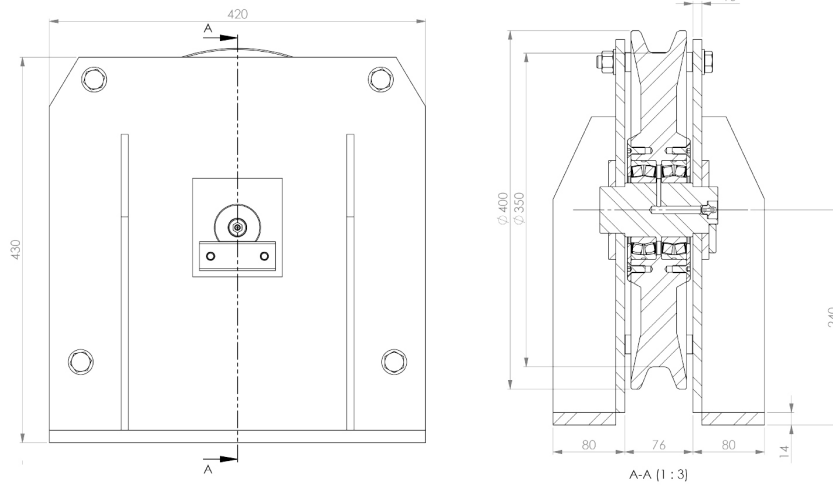

### Technical Requirements:

1. When installing the pulley block, there should be at least one wire rope installed in the direction of the force, so that the pulley base is compressed.
2. The angle between the Ø22mm wire rope and the center of the pulley should not be greater than 5°.
3. Fill 2/3 of the bearing with lithium-based grease.